

# Dura-LITE Cleat Installation

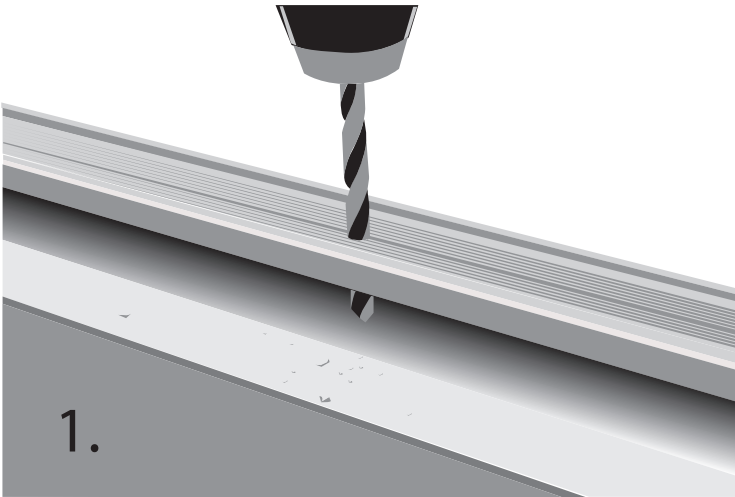

Remove the decking where you want to install your cleat then drill a 1/4" hole in the large middle groove as shown above.



Place a truss head bolt in one side of the cleat and down through the drilled hole.

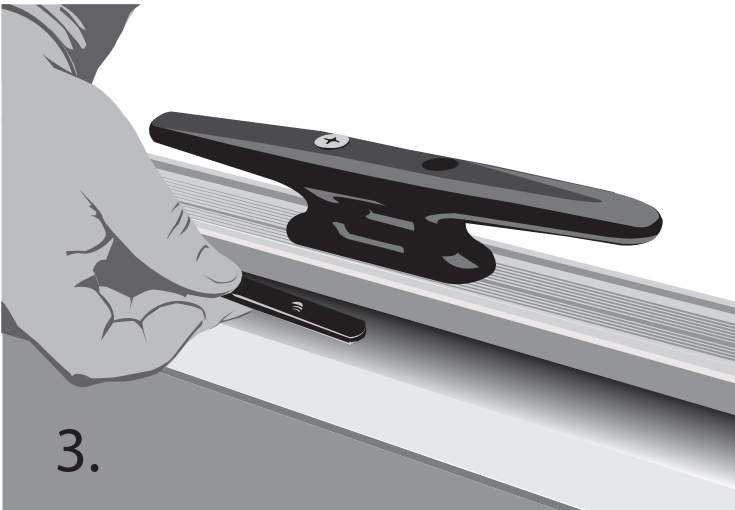

Take the weld nut and hold it on the under side of the drilled hole so it meets the threads on the truss head bolt.



Use a phillips screw driver to tighten the truss head bolt into the weld nut.

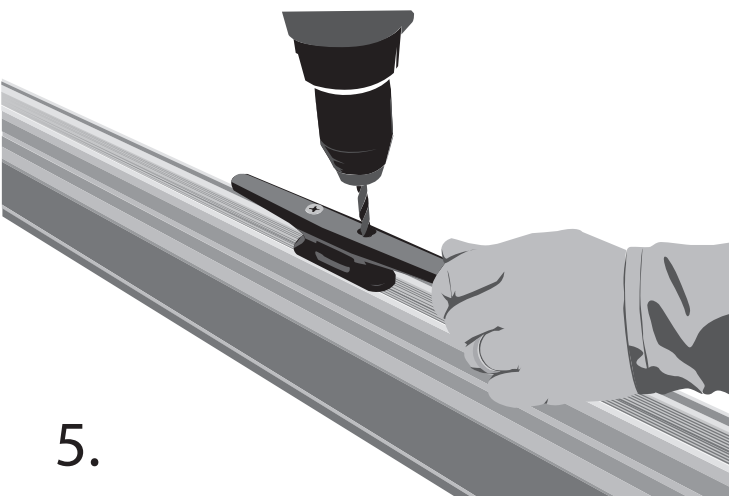

Firmly hold your cleat parallel with the dock frame and drill the second hole for your cleat.

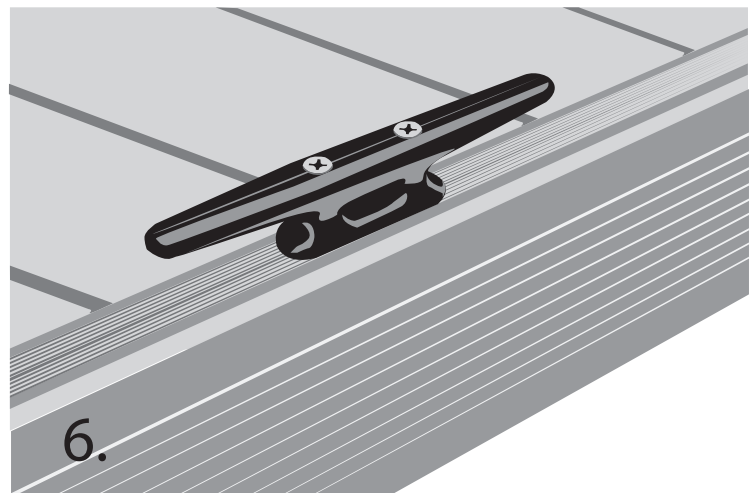

Tighten one more truss head bolt into a weld nut, insert the decking and it's complete.